

12-1-2017

# Homewood Golf Course Clubhouse Design

John Jacobs

*Iowa State University*, [jljacobs@iastate.edu](mailto:jljacobs@iastate.edu)

Justin Matticx

*Iowa State University*, [jmatticx@iastate.edu](mailto:jmatticx@iastate.edu)

Mitchell Rosburg

*Iowa State University*, [mrosburg@iastate.edu](mailto:mrosburg@iastate.edu)

Christopher Weldon

*Iowa State University*, [cjweldon@iastate.edu](mailto:cjweldon@iastate.edu)

Follow this and additional works at: <http://lib.dr.iastate.edu/tsm415>



Part of the [Bioresource and Agricultural Engineering Commons](#), and the [Industrial Technology Commons](#)

---

## Recommended Citation

Jacobs, John; Matticx, Justin; Rosburg, Mitchell; and Weldon, Christopher, "Homewood Golf Course Clubhouse Design" (2017).  
*TSM 415 Technology Capstone Posters*. 12.  
<http://lib.dr.iastate.edu/tsm415/12>

This Poster is brought to you for free and open access by the Iowa State University Capstones, Theses and Dissertations at Iowa State University Digital Repository. It has been accepted for inclusion in TSM 415 Technology Capstone Posters by an authorized administrator of Iowa State University Digital Repository. For more information, please contact [digirep@iastate.edu](mailto:digirep@iastate.edu).

John Jacobs, Justin Matticx, Mitchell Rosburg, Christopher Weldon

## Homewood Golf Course Clubhouse Design

City of Ames Parks & Recreation Department, Ames, Iowa



### Problem Statement

- Inefficient patron flow
- Inefficient employee flow
- Inefficient product flow
- Physiological and physical barriers

### Objectives

- Create multiple efficient facility layout plans
- Decrease both physical and physiological barriers

### Methods

- Coursework Applied
  - TSM 444 (Facility Planning)
  - TSM 440 (Lean Manufacturing)
  - TSM 216 (Advanced CAD Topics)
  - ABE 273 (2-D AutoCAD Application)

Current Facility Photo



Current Facility Layout

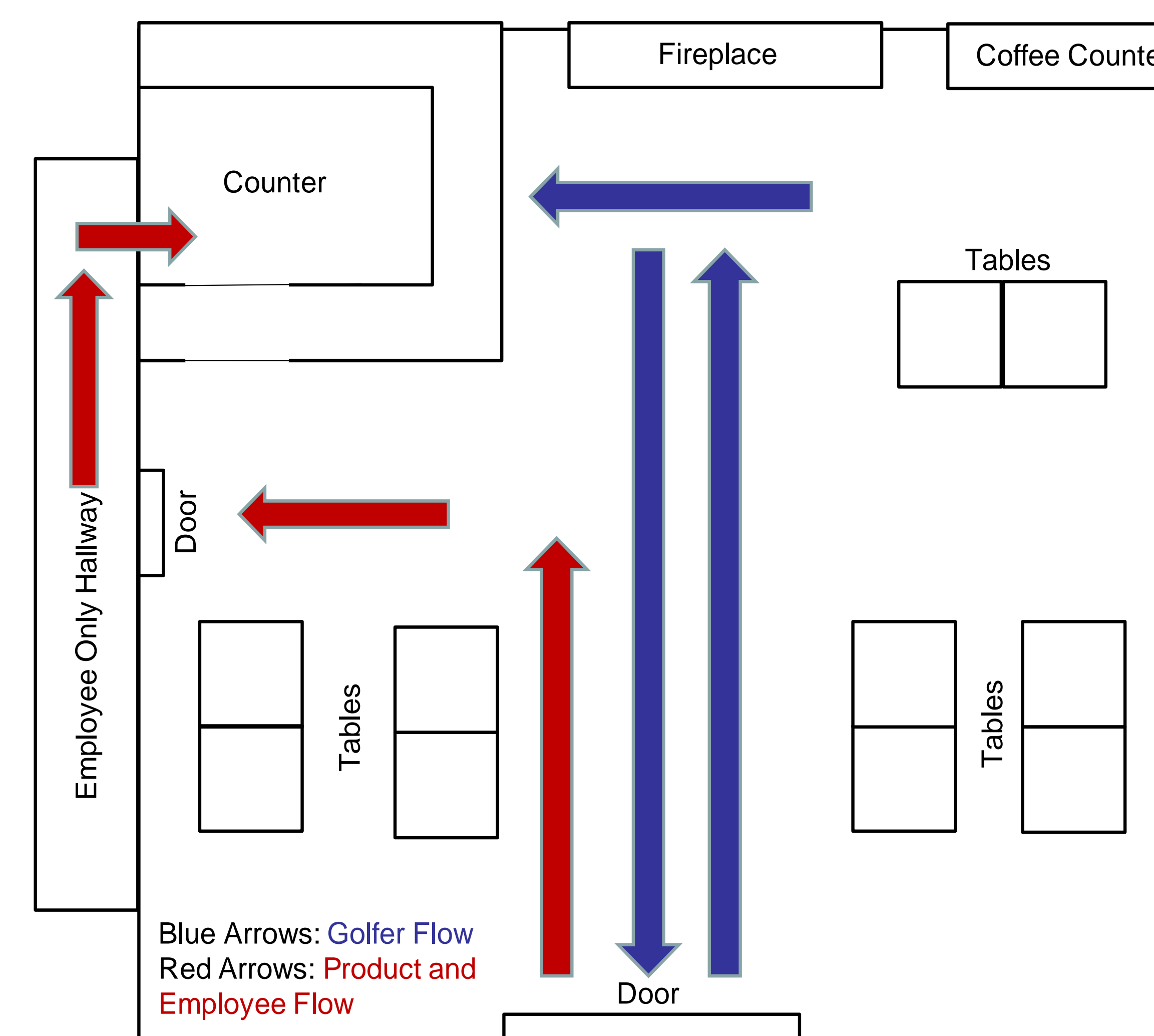

### Proposed Solutions

- Provide quantifiable layout options for staff/patron interaction
- Include an open community area with private rental capability

### Major Outcomes

- Maximize service efficiencies
- Minimize staff travel distance
- Maximize patron access to staff, restrooms, and services

### Benefit to Client

- Maximize staff and patron interaction
- Maximize product flow
- Reduce check-in time
- Provide useful facility for all seasons

### Additional Facility Improvements

- Indoor restrooms
- Community room
- Office area
- Storage area
- Larger facility

